

MAKING EXCELLENCE A HABIT



THINKING SCHOOLS  
ACADEMY TRUST



MARITIME  
ACADEMY

# Introduction

---

Welcome to Maritime Academy, a brand-new secondary school welcoming its second cohort in 2023. As a student at Maritime, your child will be a pioneer, leading the way for future students and building the foundations of our school's history.

Our unique Academy is built on an ethos of excellence: our aim is to 'Make Excellence a Habit' for every one of our students. Students at Maritime Academy are encouraged to be their best selves, recognise their potential and aim high. We offer an inclusive and safe environment for all, which equips them with the tools, knowledge and habits they need to excel in life after school. Our mission is to develop our students into lifelong learners, with skills that are transferable and highly sought after by employers, setting them up for success in later life.

Maritime Academy is proud to be part of the Thinking Schools Academy Trust's Strood Hub, which comprises of All Faiths Children's Academy, Cedar Children's Academy and The Gordon Children's Academy. While children who already attend a Thinking School will be familiar with our unique cognitive approach to education, it is also a very exciting proposition for students from outside the Trust to join our family and embark on a new learning journey.

Maritime Academy offers a first-class education with a curriculum filled with a variety of opportunities for every student to explore their talents and pursue their passions. From lunchtime clubs and school trips to sports and Arts opportunities, our Academy offers a broad and enriching curriculum which transforms life chances. Our temporary home in Twydall boasts a range of fully equipped classrooms and specialist teaching areas to support these activities.

We are delighted to welcome you to Maritime Academy. We are thrilled to be leading this new secondary school and to be offering an outstanding learning environment where children receive an education with a curriculum designed to develop critical thinkers and lifelong learners, brimming with self-confidence and an excellent array of skills.

At Maritime, our mission is to offer a unique opportunity to learn in a modern setting with traditional values. Our school ensures that students are confident, respectful and responsible young people who are able to face the challenges of modern society. We believe that through our traditional ethos and values, we have created an environment where students have respect for where they learn, who they learn with and who they are as unique, aspirational young people.

We expect the highest standards of academic performance and personal excellence from our students, so that every student is able to be their best self and shape their success. Our goal is to foster a belief in every young person that they can be who they choose to be, and we will provide the very best academic and pastoral support to ensure they reach their true potential.

Joining a brand-new school offers an exciting opportunity to our students, as they will help to shape the Maritime Academy's foundations. We look forward to sharing this experience with our young people, as we build a culture of high aspiration, high expectation and success together.

# Message from our Principal

---

We will embark on our journey as a Thinking School to achieve the prestigious Thinking accreditation from the University of Exeter. Our curriculum will reflect this through its cognitive framework designed to shape the attitudes, habits and mind-set of all our students, developing them into inquisitive, self-confident and creative young adults. The leadership team at Maritime will not only ensure the highest quality of education, safety and student wellbeing: as the school grows, we will continue to recruit a team of diligent, hard-working and enthusiastic teachers who share our school values to keep our students passionate about learning.

We thank you for your time and interest in our Academy and look forward to working in partnership and support of one another in our mission to cultivate excellence from every student.



Matt Evans  
Head of School



Jody Murphy  
Director of Education

# Proud to be Medway

Maritime Academy is proud to exist and thrive in Medway. Medway is a fascinating and diverse place steeped in history, with a rich military and maritime heritage. Medway takes its name from its river, and over centuries, the river has played a major role in the heritage and development of the area: we therefore wanted to recognise this within our school ethos and culture.

The identity of Maritime Academy reflects our links to Medway's history. The building brick work and wooden cladding of our new building was chosen specifically to reflect the industrial heritage of the area, while our logo represents a modern trident.

The trident as a symbol is linked with many aspects of history, however, we adopted the link from Britannia and how Medway has supported the naval endeavours of our country throughout history. The trident has been used to symbolise **strength, pride, and unity**, three characteristics we embody as a school.



# Part of The Thinking Schools Academy Trust

The Maritime Academy is part of The Thinking Schools Academy Trust, a multi-academy trust previously ranked by the Department for Education as the highest-performing trust in the UK for the performance of its secondary schools.

The Trust comprises of both primary and secondary schools across Medway, Kent, Portsmouth and Plymouth, and shares an ethos of excellence through a whole school integration of cognitive education.

As a Trust, we strongly believe that providing a unique cognitive education and developing our young people into adaptable and resilient thinkers is the best way to transform their life chances and equip them for the future. It is through this approach that we work to “make learning irresistible”.

A Thinking School is unique in its focus on teaching students the tools they need to become life-long learners, and to develop the best possible habits for success in school and beyond. Thinking Schools provide educational communities which unite students and staff in learning how to think reflectively, critically and creatively.

A Thinking School is more than just a title: to be officially recognised as a Thinking School, a school must undergo external assessment and accreditation from Exeter University, a journey which Maritime Academy is proud to be embarking on.

## Transforming Life Chances

All schools in the Thinking Schools Academy Trust share a common goal: to transform the life chances for every student. Opportunities are a right, not a privilege, and we work to ensure that all our students have the support they need to be their best selves and develop the skills they need to achieve this.





# Our Values and Ethos

---

## Making Excellence a Habit

Aristotle was an ancient Greek philosopher. His views shaped scholarship, and he has been called 'the father of logic', amongst other titles. A quote attributed to Aristotle is, '**We are what we repeatedly do. Excellence, then, is not an act, but a habit.**'

We want our students to be their best self: in order to achieve this, they need to develop effective habits across school life. Excellence requires determination to develop the skills needed to be an effective learner. To achieve excellence in all areas of school, our students will understand how thinking tools and effective habits can transform their life chances and enable them to shape their success.

## Strength

Students at Maritime Academy will demonstrate strength in character. They will take responsibility for their actions and develop the skills of resilience, initiative, tenacity, integrity and morality to take safe risks and be courageous.

Our students will be determined, demonstrating commitment and perseverance to overcome challenges to achieving success and being their best selves.

## Pride

Students at Maritime Academy will demonstrate pride in attending a Thinking School. They will illustrate pride in their aspirations, achievements, personal qualities and the contributions they make to the school and wider community.

Our students will have a strong connection to our school, representing our values and ethos through their excellent habits and impeccable conduct.

## Unity

Students at Maritime Academy will be united as a community to support each other. They will demonstrate respect for where they learn, who they learn with, and who they are as unique, aspirational young people. All students will hold a united responsibility and commitment to sustainability.

Our students will ensure that our school is a calm and purposeful environment where everyone can learn and flourish.

# Primary Transition

The transition from primary school to secondary school is one of the biggest changes our children will have ever experienced, but it is also one of the most exciting.

Children's primary education is the essential foundation needed to support their ability to embark on a new and exciting journey into secondary education. We believe in a 'through-education model' with a core understanding of children's early learning in Reception classrooms right through to shaping them into young adults ready for the world of work, further study and University. At Maritime, we value children's primary school learning and aim to build on their success throughout Key Stage 3 and beyond.

Moving to secondary school offers children exciting exposure to opportunities to learn and immerse themselves in new experiences, as well as the chance to develop important social skills by making new friends and taking part in different activities. Our students are encouraged and supported to step out of their comfort zones and embrace new and different situations.

During the transition process, we work with our local primary schools to prepare our children for their move to secondary education. We will provide them with resources, visits and a transition day, to ensure that their voyage to Maritime is as smooth-sailing as possible.



# Sixth Form

Providing a wealth of opportunities is essential in enabling students to become masters of their own destiny.

As such, Maritime Academy will be offering a Sixth Form education to students looking to further challenge themselves academically through the pursuit of A-level qualifications.

Maritime Academy will wholly support this, and will offer a Sixth Form education in a school environment with which students are comfortable and familiar. Maritime Academy will open to prospective Sixth form students from September 2027.



# Our Curriculum

Our curriculum is built on Maritime's five 'waves' of learning. Our students will benefit from a strong culture of high expectations and aspirations throughout the Academy, based on:

**Academic excellence:** Ensuring our students are supported to excel in all areas of the curriculum to achieve the highest standards of academic outcomes and personal development.

**Independent Learning:** Ensuring our students are able to make informed choices and take responsibility for their achievements and success. They use the tools available to them to actively engage in learning and work hard to be their best self.

**Meta-cognitive thinking:** Ensuring students can think about their own thinking by planning, monitoring and assessing their own understanding and performance. They have critical awareness of their thinking and how to develop themselves as effective learners.

**Retrieval:** Ensuring that our students are able to effectively rehearse and recall the essential knowledge that they need to know and understand from our curriculum.

**Maritime Habits:** Ensuring our students develop effective habits of learning and personal conduct to establish a calm and purpose community.

At Maritime Academy, selected students may follow our **Accelerate Pathway**. Students in this pathway follow a structured curriculum that focuses on achieving rapid progress through an accelerated pace of learning. We will work closely with our Medway Trust grammar schools, The Rochester Grammar School and Holcombe Grammar School, to shape our curriculum and help students think about their aspirations and further education.



# The Fleets

As part of our commitment to establishing a school that celebrates Medway's rich naval heritage, our Fleets (Houses) are named after famous ships that were built in Frindsbury, close to where our new school building will be located.

Students at Maritime Academy are divided into six Fleets named after historic ships. These Fleets provide opportunities for students to compete in Fleet competitions throughout the year. Students can earn points for their Fleet, with the winning Fleet rewarded each term.

The forms will be united as a Fleet, building strong relationships and camaraderie with their peers and Fleet Captains. There will be many opportunities for Fleet competitions and, as the school grows, to work with students from the same Fleet within different year groups to learn from each other, united as a team to showcase 'Excellence as a Habit'.

# One:One Devices and Digital Learning



We believe that learning doesn't just happen within the classroom: it transcends the uniform and the textbook and stays with students long after they leave school.

From day one of Year 7, students at the Maritime Academy will all receive a one:one device, so that they can benefit from a curriculum that has been developed with digital learning at its core. Learning with one:one devices is about investing in the right equipment, using modern learning techniques, offering a blended approach, teaching vital skills and trusting students to work and learn as adults.

As a Thinking School, we are proud of our cognitive approach to education; we put an understanding of how the brain learns at the heart of all that we do. Our one:one digital five 'sails' of learning strategy supports students by:

- Reducing cognitive load
- Developing good digital citizens
- Supporting retrieval via the use of Apps and new technologies
- Scaffolding learning for students with SEND
- Improving leadership opportunities

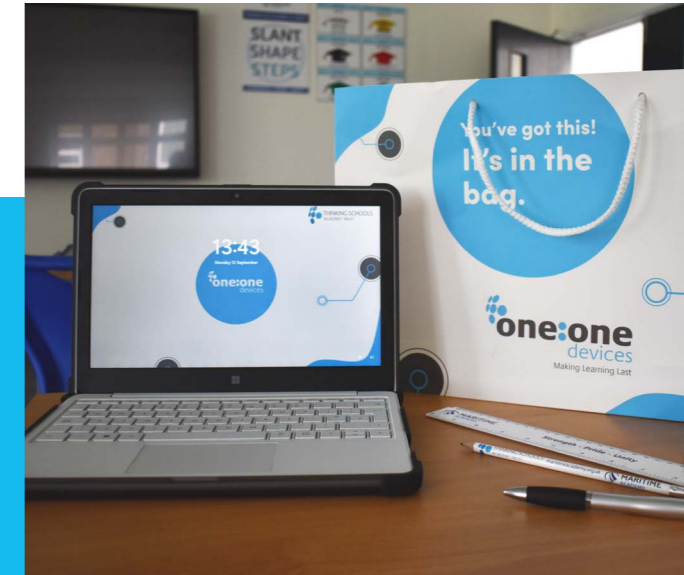

All our one:one devices are state-of-the-art, come pre-installed with the Microsoft Office suite and internet security, and are updated regularly to keep your child safe online. Your child's device will be a learning resource they can call their own. They will use their device to learn, to store information and refer back when revising, as well as to develop an understanding of digital platforms and how we use them to develop and grow.

We use software designed to encourage instant feedback between students, parents and teachers, taking the classic handwritten 'note' further, with feedback that can be shared as audio or video messages.

Our one:one device scheme is about future-proofing your child for careers that may not even exist yet, and ensuring that they leave secondary education with the right level of digital literacy. Our scheme allows us to prepare and empower our young people with the tools and knowledge they require to meet the modern needs of further education and employment.

# Our School Twydall

Our temporary home in Twydall has been developed as a fantastic learning environment for our young people. With lots of outdoor space, specialist rooms such as Science laboratories and a variety of tailored classrooms, our Twydall site provides a great space for our current students to learn and grow together.

## The Galley

A key value at Maritime is Unity: we want our students to collaborate, communicate effectively with each other and create strong bonds of trust and friendship. The Galley, where our students receive their break and lunch time meals, has a unique layout, in which students sit in their Fleet groups and dine as a community. The art of conversation and socialisation is an important skill for students to master, and our unique lunch structure supports the development of these lifelong tools.

## Transport

While Maritime Academy exists on its Twydall site, we offer free transportation for all students. Our Maritime buses collect students from three stops in Strood and bring them to and from our site in Twydall safely and efficiently.







# Our School Frindsbury

The construction of our permanent home in Frindsbury, Strood, is underway. We have worked exceptionally hard to design a school that supports our mission to offer a unique opportunity for students to learn in a modern setting with traditional values.

Our new school has been designed with our students and the wider environment in mind. The outside space around the school will contain a wealth of vegetation as well as supporting our sustainability aims with electronic car charging points, bike racks and recycling stations.

The building has been assessed for access to natural light to ensure bright classrooms. This ensures that every room optimises the natural light streaming into the room to support our calm, purposeful and respectful atmosphere.

Classrooms and teaching areas will be grouped into subject specialisms. Our children will benefit from the ground floor largely dedicated to the Arts, the first floor will include Maths, English and the Sans Pareil Library, with the second floor holding specialist Science laboratories and Humanities rooms.

Our new site will boast a brand-new Thinking Fitness area, open for students to use during the day and members of the public in the evenings. All profit generated by Thinking Fitness memberships will be

recycled back into our Trust to support our mission of transforming life chances. The Thinking Fitness area will include a fitness studio equipped with state-of-the-art equipment, a designated sports hall and a MUGA (multi use games area).

Our students will also have a range of social spaces to choose from, including a brand-new dining hall (The Galley) and an outdoor seating and café area.



# Building a Sustainable School

Maritime Academy is committed to sustainability and preserving our planet for future generations. We are environmentally conscious in our practice. We:

- Monitor targets for energy, water and waste reduction;
- Invest in transportation initiatives for students and staff;
- Review and expand sustainability learning material within the curriculum;
- Encourage individuals to promote their own sustainability activities;
- Make informed business decisions with a focus on environmental and social considerations;
- Work to reduce carbon emissions.

We are working closely with our partners from Bowmer + Kirkland, the Department for Education (DfE) and Medway Council to build a new school that boasts incredible, state-of-the-art facilities to compliment the highest standard of teaching and learning, whilst having minimal impact on the wider environment.

The school will be developed to deliver a carbon neutral build, and we believe that we have a responsibility to continue this work to secure the school's long term environmental sustainability aims.

Many young people hold strong concerns about climate change and the challenges that this might present for future generations. At Maritime

Academy, we work together as a community to be responsible and respectful for where we live and learn. Sustainability is a huge part of everyday school life and is incorporated into our curriculum. We are working to reduce the use of single-use plastics in our schools, as well as actively recycling and encouraging greener ways to travel to school.

Working closely with Bowmer + Kirkland, we will be incorporating sustainable initiatives throughout the new build school such as only using LED lights, ventilation optimisation to naturally stabilise the temperature in the classrooms, and responsibly resourced materials.

We have a proud student team of "Engineering Officers" that form part of our sustainability committee which encourages students to get involved with the school's sustainability planning.





Romany Road,  
Twydall,  
Gillingham,  
Kent, ME8 6JH

0333 360 2150  
[office@maritimeacademy.org.uk](mailto:office@maritimeacademy.org.uk)  
[www.maritimeacademy.org.uk](http://www.maritimeacademy.org.uk)

